

# **BATTERY OPERATED DC MOTORS**

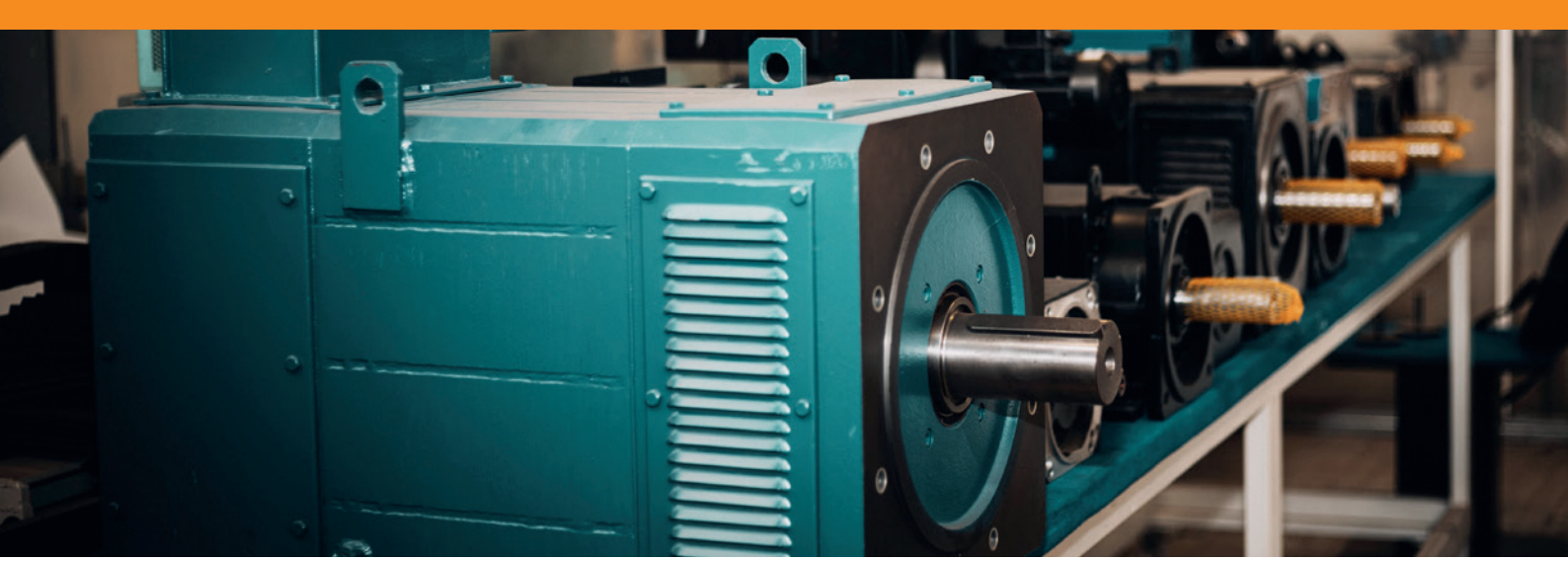

**Green Energy**  
**SP & NP SERIES**



Orange1 Sicme was born from the fusion of Sicme Motori and Magnetic. Sicme Motori is an Italian manufacturer of electric motors and generators for industrial applications, founded in Turin – Italy, in 1967. Over the years, the company has developed new technologies, expanding its products range and its geographical coverage. Magnetic Motors, founded in 1973 under the name O.C.E.M., manufactured small rotating electrical machines specifically designed to be used for variable speed application. The company headquarters have been in Montebello Vicentino since 1986. Today Orange1 Sicme designs and manufactures a wide range of variable speed electric motors suitable for many industrial applications

## PRODUCTION PLANTS

LOCATION	MOTORS PRODUCTION
<b>MONTEBELLO VIC.NO - ITALY</b> 36054 (VI) Via del Lavoro 7	AC VECTORIAL MOTORS DC MOTORS BRUSHLESS MOTORS TORQUE MOTORS
<b>TORINO - ITALY</b> 10156 (TO) Strada del Francese 130	AC MOTORS DC MOTORS GENERATORS SERVICE RELUCTANCE MOTORS

## SP & NP SERIES

# Battery operated DC motors

Orange1 Sicme battery-operated DC motors are designed for a wide range of applications, but find their ideal use in compressors and as emergency motors for lubrication pumps. In situations where the AC mains voltage fails, the batteries are automatically activated to power the motor, which in turn drives the pump, ensuring continuous and reliable operation.

This application, particularly for lubrication pumps, is very similar to that of our ATEX or IECEx explosion-proof motors. However, Sicme Orange1 battery powered "SP" series DC motors are designed to operate in safe environments and do not require certification for specific hazards.

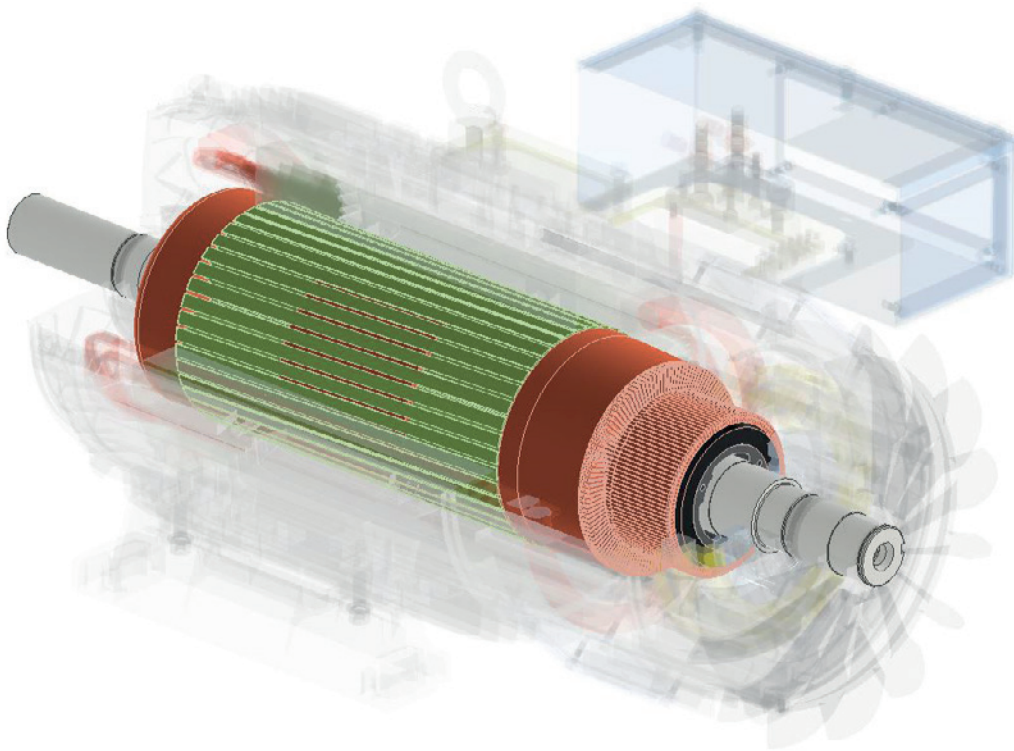

### *The strengths of our battery-powered DC motors include:*



**Product optimisation:** specifically developed for emergency applications in lubrication pumps.



**Reliability and safety:** they guarantee continuous operation even in the absence of AC power.



**Versatility:** suitable for a wide range of uses, thanks to their robust and flexible design.

## Performance Data SP160/180

Frame Size SM	Speed [rpm]				
	1000	1500	2000	2500	3000
SP 160 L2	6,8	9,8	13	15,8	19
SP 180 L2	10,5	16,5	21	25,5	30
SP 225 L2	Performance Data Coming soon				

Values in [kW]

## Dimensions - Frames SP160/180

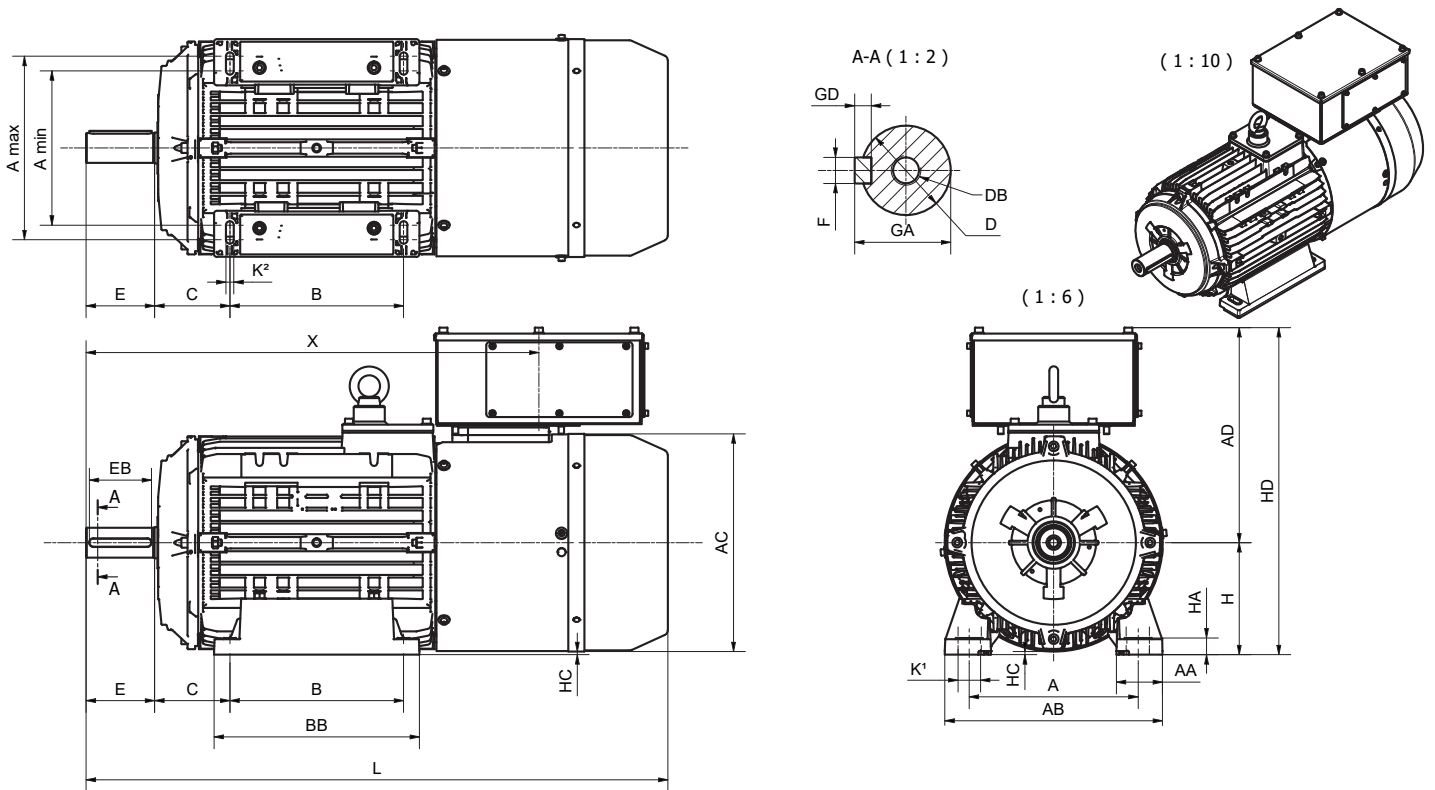

Type	A	A min	A max	AA	AB	AC	AD	B	BB	C	D	DB
SP160L2	254	239	269	72	318	∅309,5	264	252	308	108	∅42 K6	M16X2
SP180L2	271	248	295	74	350	∅350	345	279	330	121	∅48 K6	M16X2

Type	E	EB	F	GA	GD	H	HA	HC	HD	K	K²	L	X
SP160L2	110	100	12 h9	45	8 h11	160	25	2,4	425	15	14,5	780	493
SP180L2	110	100	14 h9	51,5	9 h11	180	27	5	526	36	12,5	935	728

## Performance Data - NP Series

Frame Size SM	Speed [rpm]				
	1000	1500	2000	2500	3000
NP 80	0,5	0,63	0,85	1	1,2
NP 90	1	1,3	1,7	2,1	2,3
NP 100	1,7	2,1	2,8	3,5	4
NP 112	2	2,7	3,4	3,9	4,2
NP 132	2,4	3,2	3,7	4,1	6
NP 160	4	6	7	8,5	10

Frame Size SM	Speed [rpm]				
	1000	1500	2000	2500	3000
NP 180	6	12	15	17	18
NP 200	10	22	27	33	37
NP 225	18	33,5	40	42	45
NP 250	38	45	55	65	-
NP 280	55	70	80	90	-
NP 315	65	90	110	-	-

## Dimensions - Frames NP80/100/112

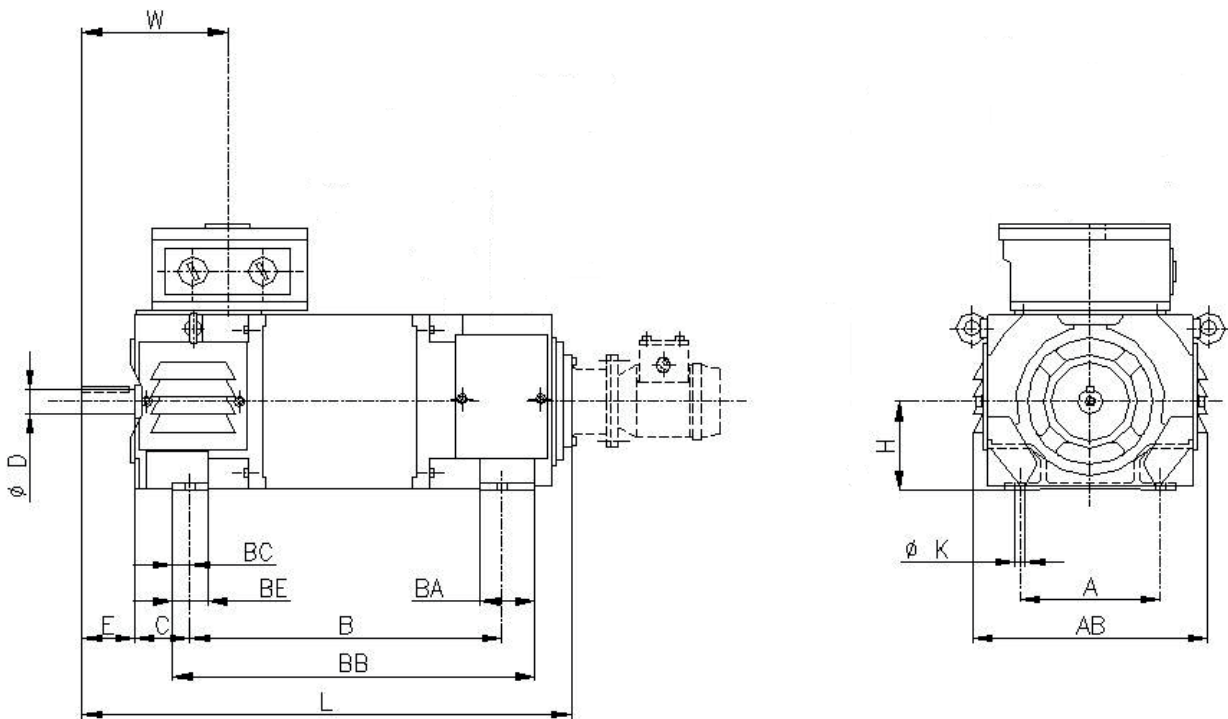

Type	D	E	C	B	BA	BB	BC	BE	L	W	H	K	A	AB
NP 80 NS2	24 j6 with key	50	50	265	40	304	15	35	407	130	80 0 -0,5	10	125	213
NP 80 NM2				290		329			432					
NP 80 NL2				325		364			467					
NP 90 NR2	28 j6 with key	60	56	285	40	325	19	35	460	140	90 0 -0,5	10	140	240
NP 90 NS2				315		355			490					
NP 90 NM2				355		395			530					
NP 90 NL2				400		440			575					
NP 100 NR2	38 k6 with key	80	63	355	70	412	20	40	560	168	100 0 -0,5	12	160	263
NP 100 NS2				395		452			600					
NP 100 NM2				445		502			650					
NP 100 NL2				475		532			680					
NP 112 NS2	38 k6 with key	80	70	350	65	387	21	55	602	265	112 0 -0,5	12	190	285
NP 112 NM2				390		427			642					
NP 112 NL2				440		477			692					

## Dimensions - Frames NP132-200

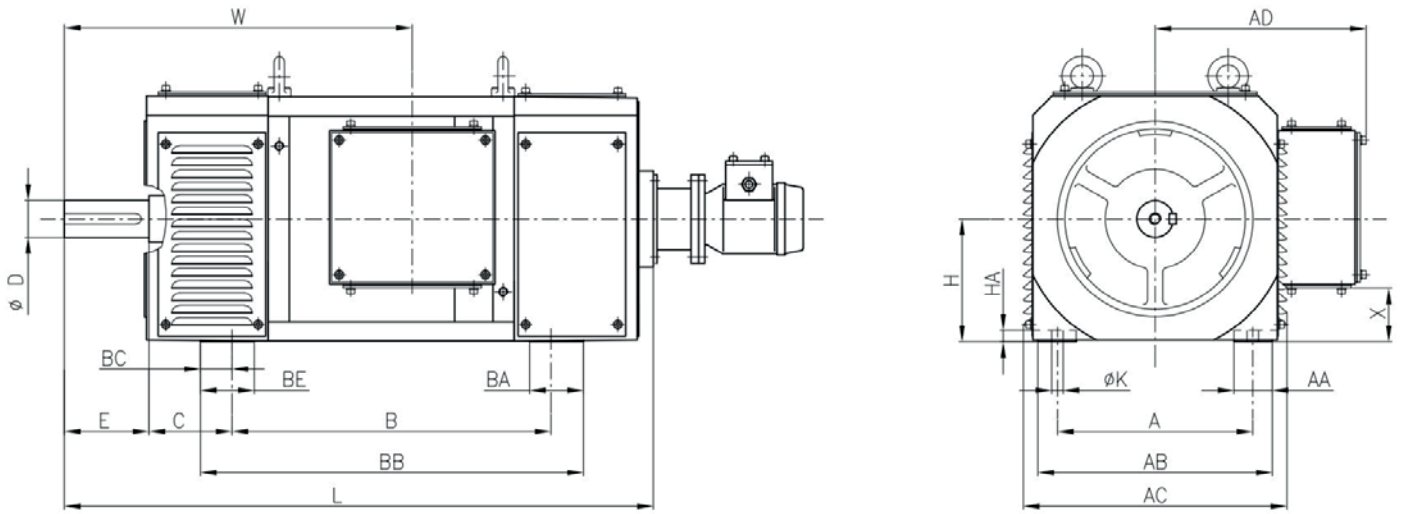

Type	D	E	C	B	BA	BB	BC	BE	L	W	H	K	A	AB	X
<b>NP 132 K(N)S2</b>	38 k6 with key	80	89	325	60	393	35	60	625	355	132 0 -0,5	12	216	287	50
<b>NP 132 K(N)M2</b>				365		433			665	395					
<b>NP 132 K(N)L2</b>				415		483			715	445					
<b>NP 132 K(N)X2</b>				445		513			745	475					
<b>NP 160 K(N)S2</b>	48 k6 with key	110	108	415	70	498	41	70	765	452	160 0 -0,5	15	254	343	70
<b>NP 160 K(N)M2</b>				465		548			815	502					
<b>NP 160 K(N)L2</b>				530		613			880	567					
<b>NP 160 K(N)X2</b>				570		653			920	607					
<b>NP 180 K(N)S4</b>	55m6 with key	110	121	475	115	595	41	80	905	492	180 0 -0,5	15	279	390	80
<b>NP 180 K(N)M4</b>				530		650			960	547					
<b>NP 180 K(N)L4</b>				605		725			1035	622					
<b>NP 180 K(N)X4</b>				650		770			1080	667					
<b>NP 200 K(N)S4</b>	38m6 with key	140	133	480	120	617	55	90	975	527	200 0 -0,5	19	318	423	83
<b>NP 200 K(N)M4</b>				545		682			1040	592					
<b>NP 200 K(N)L4</b>				630		767			1125	677					
<b>NP 200 K(N)X4</b>				680		817			1175	727					

## Dimensions - Frames NP225-315

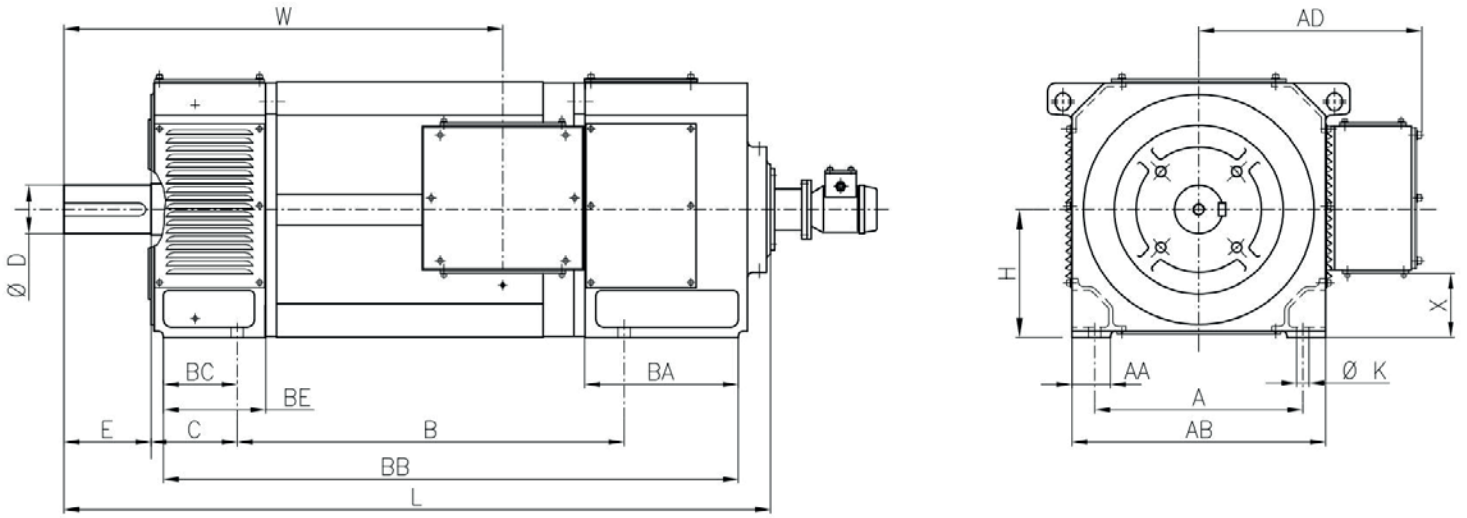

Type	D	E	C	B	BA	BB	BC	BE	L	W	AD	H	K	A	AB	X
<b>NP 225 K(N)S5</b>	85m6 with key	170	149	785	270	1033	125	160	1284	777	410	225 0 -0,5	19	356	445	105
<b>NP 225 K(N)M5</b>				835		1083			1334	827						
<b>NP 225 K(N)L5</b>				885		1133			1384	877						
<b>NP 250 K(N)S5</b>	95m6 with key	170	168	755	300	1122	144	180	1379	857	435	250 -0,5 -0,5	24	406	495	125
<b>NP 250 K(N)M5</b>				805		1172			1429	907						
<b>NP 250 K(N)L5</b>				865		1232			1489	967						
<b>NP 280 KS6</b>	95m6 with key	170	190	845	325	1262	166	205	1519	912	500	280 0 -1	24	457	555	127
<b>NP 280 KM6</b>				905		1322			1579	972						
<b>NP 280 KL6</b>				975		1392			1649	1042						
<b>NP 315 KR6</b>	100m6 with key	210	216	833	325	1207	192	235	1504	897	533	315 0 -1	28	508	625	162
<b>NP 315 KS6</b>				933		1307			1604	997						
<b>NP 315 KM6</b>				993		1367			1664	1057						
<b>NP 315 KL6</b>				1063		1437			1734	1127						



info@orange1.eu  
www.orange1.eu



**ORANGE1 SICME S.r.l.**

**Montebello Vicentino - HQ**

Via del Lavoro 7  
36054 - Montebello Vicentino  
(VI) Italy  
Tel: 02 8002 6000

**Torino Plant**

Str. del Francese 130  
10156 - Torino  
(TO) Italy  
Tel: 011 407 6311

